



OM REALTORS™

Complete Real Estate Solution
CGRERA051222A00703





Ground Floor
510' sqft.

3 BHK Plan

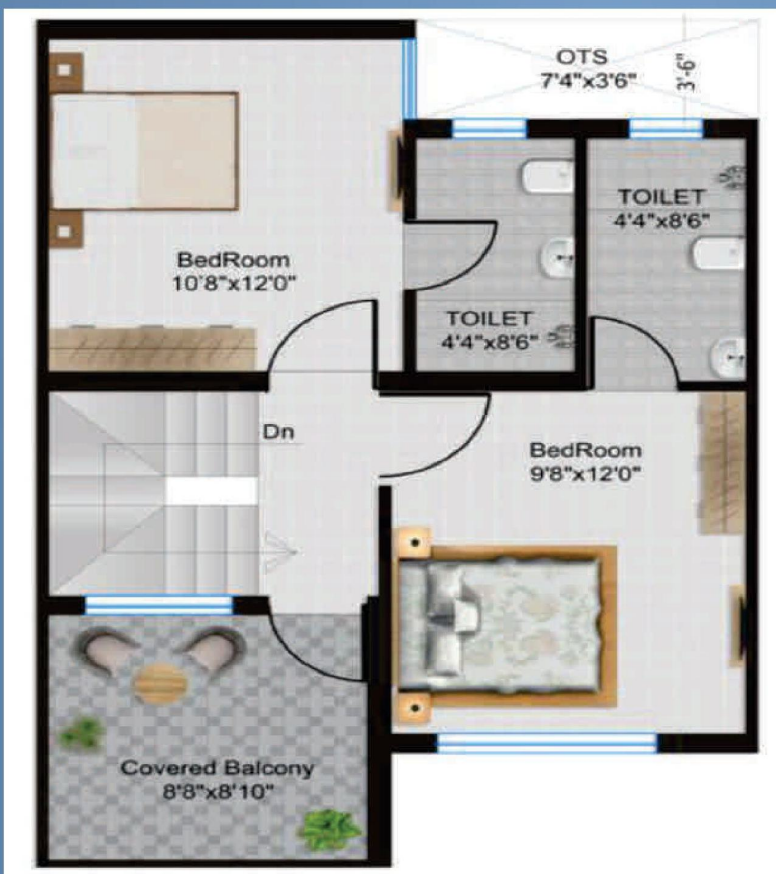

1st Floor Plan
510' sqft.

Plat Area - 19'8" x 29'-7" = 580'

Super Build. Area 1020'

Amenities :

- T & CP and Rera Approved Project
- Grand Entrance Gate
- Covered Campus With CCTV Surveillance
- Club House
- Landscaped Garden
- Children Play Area
- Wide RCC Road
- Underground Electric Cabling
- Elegant Street Light
- 24x7 Water Supply Over Head Tank
- Shiv Temple

Specifications :

- Structure R.C.C. Structure Frame
- Flooring 2'x4' Tiles
- Bathroom 7' Height Tiles
- Kitchen Granite Palatform with branded sink & 2' height dado tiles
- Wall Finish Exterior Texture with paint & internal putty with primer
- Electrification ISI High Quality Wiring & Switches
- Plumbing PVC & CPVC Plumbing fittings
- Sanitary Royal touch C.P. bath fittings & Sanitary ware
- Doors All Door in Laminate Door
- Windows 3 Track Aluminium Windows
- Over Head Tank 1000 liters HDPE Tank
- Front for Pathway Ceramic tiles

Site Address : Solus Pearl, Near V.Y. Hospital, Kamal Vihar, Raipur (C.G.)

FOR BOOKING CALL

www.omrealtors.co.in | **Follow Us:**   

Shubham Corporate, 4th Floor, Infront
of Airtel Office Telibandha, Raipur